

Silic8 AF1 AeroGel Fix Adhesive



Description:

Silic8 AF1 is a water based mineral adhesive and primer specially designed for use with AeroGel fleece, boards or tiles. Silic8 AF1 can be used for priming and adhesion, typically mineral substrates, historic plaster, stone, brick etc. Used in combination with our penetrating solutions, AF1 bonds with substrates while remaining vapour open. It can be used in combination with our other Silic8 products. Patent pending. AF1 is available in 9kg or 20kg UN certified containers.

Silic8

SILICATE MINERAL PRIMERS AND ADHESIVES

Properties:

AF1 is water-based, has no odour and is certified as **non-combustible** and **vapour permeable**. It is a natural mineral and water-glass adhesive and free from any other co-binders such as solvents, acrylic, gypsum and cement. Use to create a flexible, durable and non-combustible bond to adhere AeroGel fleece insulation to substrates prior to plastering and decorating.

Preparation

- Substrates must be **clean and dry** and free from any loose material prior to application.
- Test a small area for suitability with your specific materials before use*.
- Do not use on contaminated surfaces, extreme environments or in any unusual circumstances. Do not store or use in extremes of temperature (<5C or above 30C).
- Protect surrounding surfaces, particularly glass.
- Re-mix well before use.
- Do not store, or use in temperatures <5C or above 30C.

Application of untreated fleece

- Apply a thin layer of adhesive to the back of the AeroGel Fleece.
- Apply adhesive to the wall with a toothed trowel and press AeroGel firmly into position.*
- Where plastering directly onto fleece, apply a thin layer of adhesive as a primer.**
- Use appropriate fixings and mesh in large areas in accordance with individual specification or technical guidance.
- On highly absorbent surfaces or where increased bond strength is required, a vapour open penetrating solution such as PS1/2 is recommended.
- Plastering: Use an appropriate vapour open plaster and follow manufacturer instructions. Avoid using plaster or finishing products with excessive water content with AeroGel systems.
- Only use vapour open mineral paints with AeroGel systems.



Example of application of vapour open insulation boarding

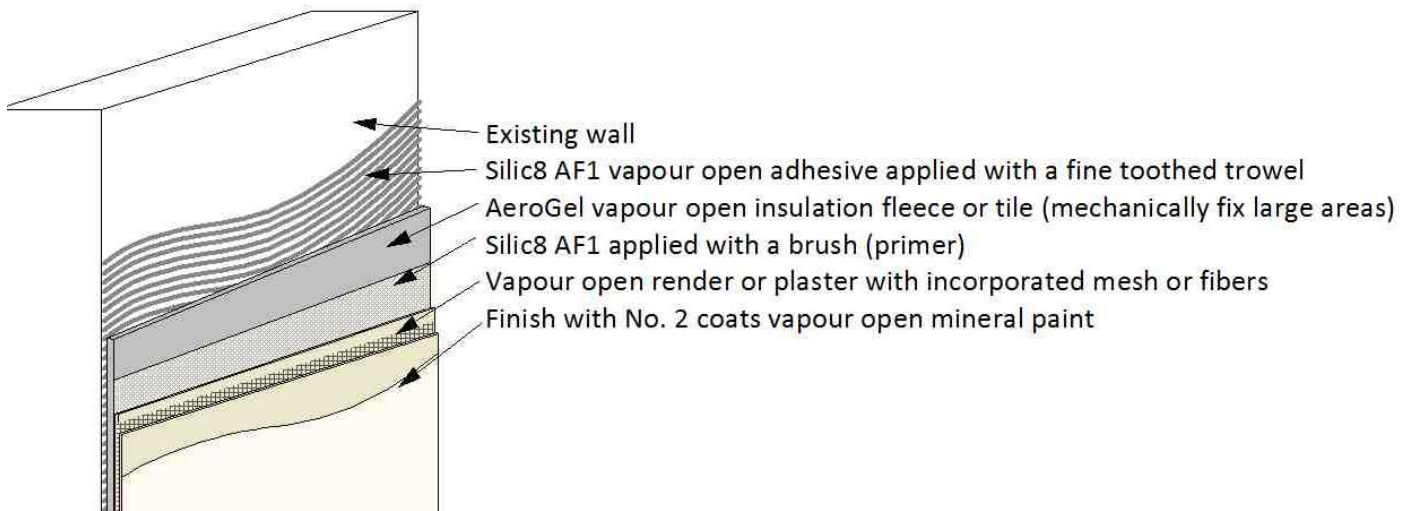

Aftercare

- Allow to dry completely before further application, plastering or decoration. Drying time is 12-36hrs depending on temperature, substrate and type of application.
- Suitable vapour open plasters and mineral paints should be used.
- Wash splashes, tools and brushes with water.
- Dispose of all surplus material in accordance with your local regulations (EWC 06 02 99).
- Cleaned tins are 100% reusable and recyclable.

Images showing typical internal wall application



Technical:

- pH value in liquid state: pH 11.1
- Odourless
- Dries white.
- Non-combustible - Aerogel Fix Adhesive has been independently tested as: Non-combustible in accordance with: CAN/ULC S114-5 (Relative Standard: BS EN 13501-1:2007)
- Non-hazardous
- No VOC's
- Application rate varies according to use; spread rate 500g/m² of prepared filler at 1mm thick
- MF1 is an interior filler adhesive with some possibility of exterior applications. Please contact our technical team to discuss your application.
- Storage life: 36 months prior to mixing if kept well sealed (protect from frost, moisture and temperature extremes)
- Water vapour permeability at 10mm thick - Very high: 0.03 sd (m) - Class 1 (very high) in accordance with EN ISO 7783.

Further Information and Safety:

- **Risk phrases:**
52/53 Harmful to aquatic organisms, may cause long-term adverse effects in the aquatic environment.
- **Safety phrases:**
S1/2 Keep out of reach of children
S26 In case of contact with eyes, rinse immediately with plenty of water and seek medical advice.
S24/25 Avoid contact with skin and eyes
S36 Wear suitable gloves and protective clothing
S61 Avoid release to the environment. Refer to special instructions and safety data sheets.
- **Relevant R-phrases**
R22 Harmful if swallowed
R36/37/38 Irritant for the eyes, respiratory ways and the skin
R43 May cause sensitisation by skin contact
R50/53 Very toxic to aquatic organisms. May cause long-term adverse effects in the aquatic environment

This information is given to the best of our knowledge. However, this shall not constitute a guarantee for any specific product features and shall not establish a legally valid contractual relationship. This document does not dispense the user from knowing and applying all rules and practices related to his activity and must not be considered exhaustive. It does not exonerate the user from other obligations to be respected, supplementary or prescribed, outside the content of this document for which he remains solely responsible.

* We do not take responsibility for compatibility with any of the suggested or unlisted substrates types. Substrates should be tested for suitability before use, for which we accept no liability. No liability taken for misuse or failures outside our control and no liability for consequential loss howsoever arising.

**AF1 Can be diluted with no more than 5% water or 10% PS2.